

1. Historic Name (s) "Young's Ferry" House \*

Original Owner Samuel W. Young

Present Name Young's Ferry House

3. Owner's Name Paul Vance

4. Owner's Address Rt. 1 Richardsville *Bowling Green side*

5. Location N. end of Young's Ferry Rd. at Green River

6. Open to Public Yes  No

7. Visible from road Yes  No

8. Ownership Private  Local  State  Federal

9. Local Contact/Organization

22. ADD/County BARRETT

23. Zoning Classification Magisterial District

24. U.S.G. S. Quadrant (15'/75') Reedyville

25. UTM Reference Zone 116 Easting 547280 Northing 41111760

26. Prehistoric Site  Historic Site  Object  Structure

27. District Name: Yes  No

28. Significance Evaluation NR

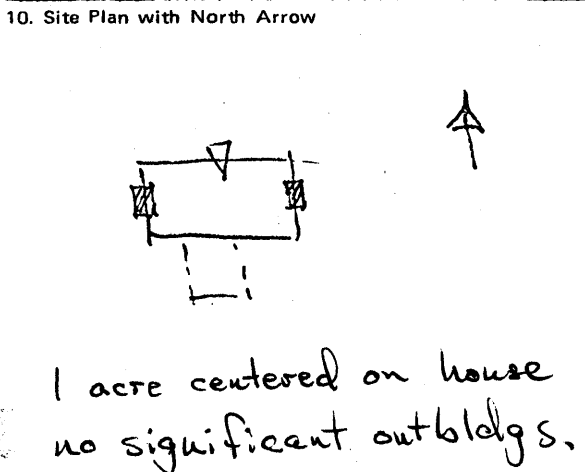

11. Architect

12. Builder Samuel W. Young \*

13. Date Circa 1850s \*

14. Style dogtrot

15. Original Use dwelling

16. Present Use dwelling

17. Condition Interior  Exterior good

29. Status National Landmark  National Register  Landmark Certificate  Kentucky Survey  Local Landmark  HABS/HAER

30. Theme Primary Architecture Secondary log houses Other commerce transportation

31. Endangered Yes  No

18. Description 1 1/2 story log - square notched dogtrot form - recent recessed door - 2 exterior stone slope shouldered chimneys - cinder block room (1 story) in ell alignment

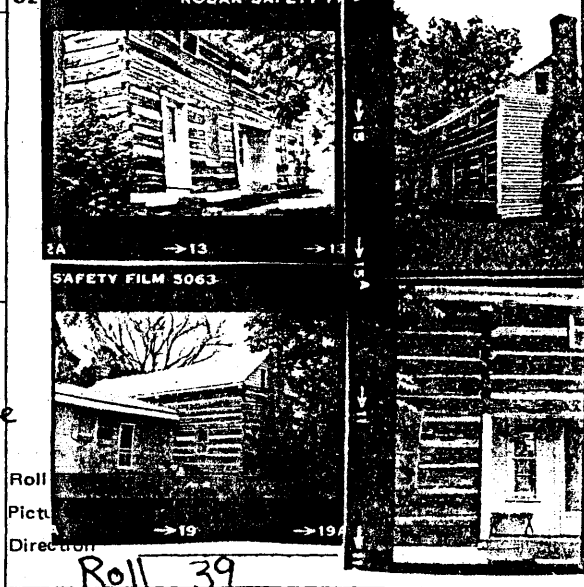

19. History \* Samuel W. Young operated the ferry that connected Warren and Butler Counties - He ran the ferry for 40 years - died in 1891 - wife Catharine Young ran the ferry until a Crit Amos bought land and began another ferry - later she sold the property to Jesse Smith who began to run the ferry in 1912.

33. Tape No. Negative No. \*

34. Prepared by: KTG-JCH

35. Organization KHC

36. Date Spring 1978

37. Revision Dates 38. Staff Review

20. Significance particularly clear illustration of a common type. Original Owner had strong connections with early commerce on the ~~Barren~~ Green River.

21. Source of Information \* Sumpter, An Album of Early Warren County Landmarks

Architecture and transportation;

187. One of the best of the six surviving double pen form log houses in the county, this structure was the house of the operator of the ferry that formerly connected Warren and Butler Counties at the nearby important river crossing.

