

1. Historic Name (s) \* Moses Shobe home

Original Owner Moses Shobe

Present Name

3. Owner's Name Ruth Shobe

4. Owner's Address Rt. 1 Oakland 42159

5. Location S. side Rt. 31W; 1 1/2 m. from Edmonson Co (13 miles north of Bowling Green - 31W) line

6. Open to Public Yes  No

7. Visible from road Yes  No

8. Ownership Private  Local  State  Federal

9. Local Contact/Organization

22. ADD/County 3ARLV/WA

23. Zoning Classification Magisterial District 66

24. U.S.G. S. Quadrant (15'/75') Smiths Grove

25. UTM Reference Zone 116 Easting 568980 Northing 4104060

26. Prehistoric Site Historic Site Building

27. District Name: Yes  No

28. Significance Evaluation NR

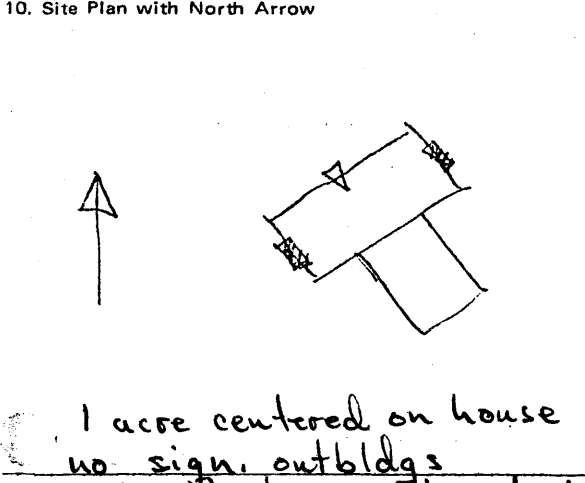

11. Architect

12. Bullder

13. Date 1850\*

14. Style Greek Revival

15. Original Use dwelling

16. Present Use " "

17. Condition Interior  Exterior excellent

29. Status National Landmark  National Register  Landmark Certificate  Kentucky Survey  Local Landmark  HABS/HAER

30. Theme Primary architecture

31. Endangered Yes  No

18. Description 2 story - 8 bay brick - unbonded front-American bond sides - wooden lintels on 1st and 2nd floor openings with bulls eye corners - transom and side lights - original 2 story ell - 2 partially exterior end chimneys - ell has shed addition - interior end chimney in ell - later porch - stone block at corner of end walls - eaves

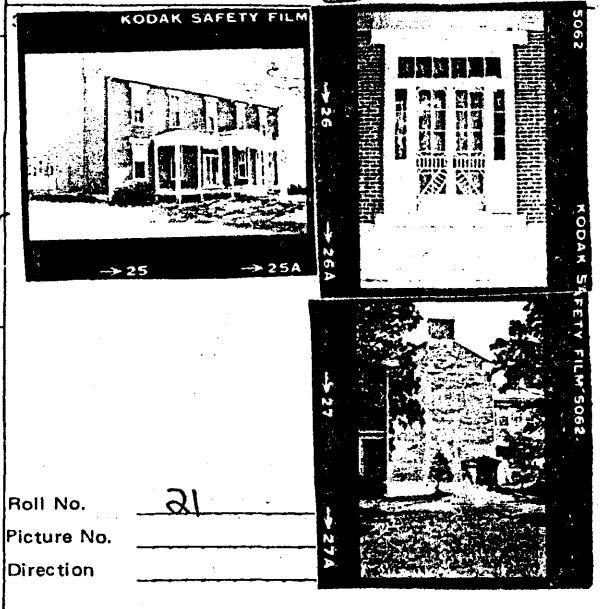

Roll No. 21

Picture No.

Direction

19. History \* Moses Shobe original owner of this home born in Va in 1806. His father Jacob Shobe was a Revolutionary War soldier who came to Ky around 1817 by way of Ohio.

20. Significance The Old Louisville Rd. became a highly travelled route in the early part of Warren County's history. This is evidenced by the many well-constructed homes in this area. Particularity clear illustration of a common style.

33. Tape No. Negative No.

34. Prepared by: KTG-JCH

35. Organization KHC

36. Date Spring 1978

37. Revision Dates 38. Staff Review

21. Source of Information \* Sumplers book

(over)

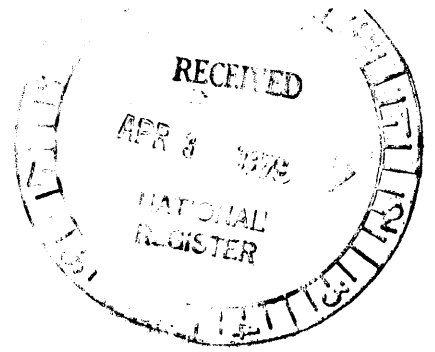

### Architecture :

5. The architectural significance of this house--it is a largely intact brick version of the standard Greek Revival I-house--is enhanced by its location on the historic main north-south route through the county, Old Louisville Road, presently US 31W. An unusual feature, the stone blocks at the ends of the cornices, perhaps link the house with the nearby Wa-16 and with an elaborate Greek Revival structure in Bowling Green, Wa-B-167.