

1. Historic Name (s) **Polk House**

Original Owner _____

Present Name **Old Polk Farm**

3. Owner's Name **William Rawlings**

4. Owner's Address **Rt 1 Woodburn**

5. Location **N. side Ming Rd; btwn College + Garden Sts; Woodburn**

6. Open to Public
 Yes No

7. Visible from road
 Yes No

8. Ownership
 Private
 Local
 State
 Federal

9. Local Contact/Organization _____

22. ADD/County **BARI V, WA**

23. Zoning Classification
 Magisterial District **III**

24. U.S.G. S. Quadrant (15'/75')
Woodburn

25. UTM Reference
 Zone **116** Easting **542380** Northing **4077280**

26. Prehistoric Site _____ Object _____
 Historic Site **Building** Structure _____

27. District Yes No
 Name: _____

28. Significance Evaluation **NR**

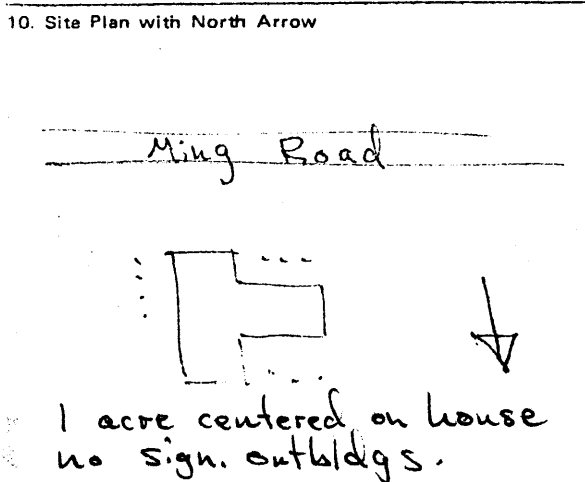

11. Architect _____

12. Builder _____

13. Date **last 1/4 19th c.**

14. Style **dec. cottage**

15. Original Use **house**

16. Present Use **house**

17. Condition
 Interior **excellent**
 Exterior **excellent**

29. Status
 National Landmark
 National Register
 Landmark Certificate
 Kentucky Survey
 Local Landmark
 HABS/HAER

30. Theme **architecture**

Primary _____
 Secondary _____
 Other _____

31. Endangered Yes No

13. Description **1 story plan - chair rails interior - original gingerbread porches - segmental openings with hoodmolds - essentially intact - key site at fringe of Woodburn - visual link between town + farm**

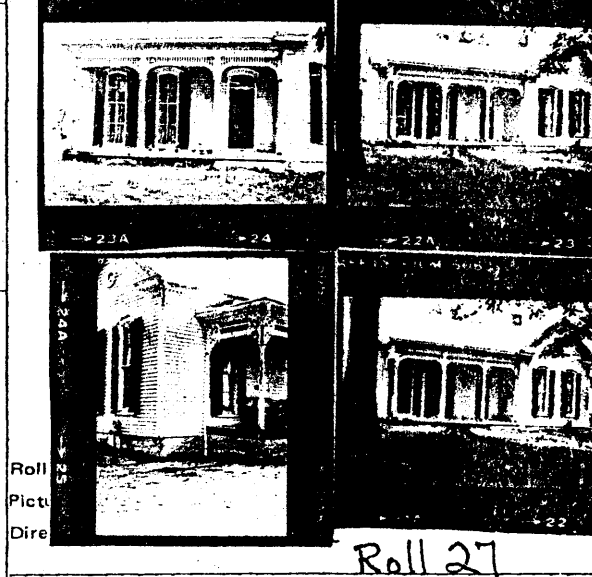

19. History _____

20. Significance **Particularly clear illustration of a common type and style; outstanding design and craftsmanship.**

33. Tape No. _____ Negative No. _____

34. Prepared by: **KTG-JCH**

35. Organization **KHC**

36. Date **Spring 1978**

21. Source of Information _____

37. Revision Dates _____ 38. Staff Review _____



Architecture:

117. One of the few decorated cottages of the late nineteenth century in the county to have survived with its entire decorative scheme intact (see Wa-22 and 54), this house is based on the T-plan type and demonstrates the nineteenth century tenet that even the most modest dwellings could be given architectural dignity through ornamentation. It is one of the best examples of its type in the county.