

KENTUCKY HISTORIC RESOURCES INVENTORY

79003534

Wa-116

1. Historic Name (s) Merritt - Hardin House *

Original Owner William W. Merritt, Sr. *

Present Name

3. Owner's Name Wm. H. Fletcher

4. Owner's Address 1129. College St., Richpond

5. Location E. side Rt. 31 W; 1 1/2 m. S. of Rt. 242

6. Open to Public Yes No

7. Visible from road Yes No

8. Ownership Private
 Local
 State
 Federal

9. Local Contact/Organization

22. ADD/County BARTON/WA

23. Zoning Classification
Magisterial District (B)

24. U.S.G. S. Quadrant (15'/75')
Woodburn

25. UTM Reference
Zone 116 Easting 542000 Northing 4080820

26. Prehistoric Site Object
Historic Site Structure
Building

27. District Yes No
Name:

28. Significance Evaluation NR

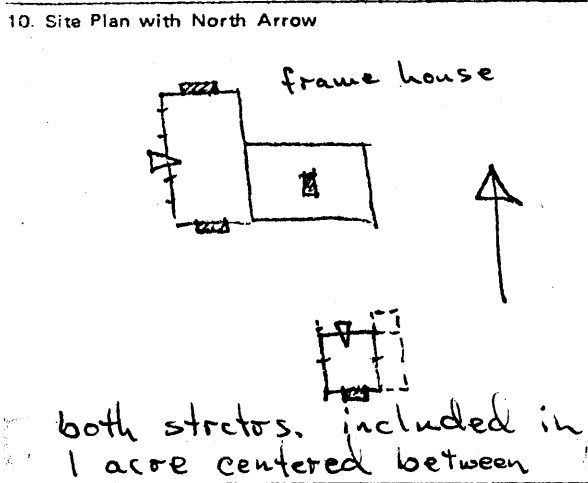

11. Architect

12. Builder

13. Date log - 1st 1/4 19th c.
frame - mid-19th c.

14. Style Greek/Fed.

15. Original Use dwellings

16. Present Use dwellings

17. Condition Interior Exterior good

29. Status National Landmark
 National Register
 Landmark Certificate
 Kentucky Survey
 Local Landmark
 HABS/HAER

30. Theme
Primary architecture -
Secondary log structures
Other

31. Endangered Yes No

18. Description 2 story - 5 bay frame - two partially exterior end chimneys - (1) square single pen log outbuilding - originally house - brick end chimney - south end - central door north side - central door west side - two windows east - transitional moldings interior - simplified federal style mantels - chimney probably rebuilt

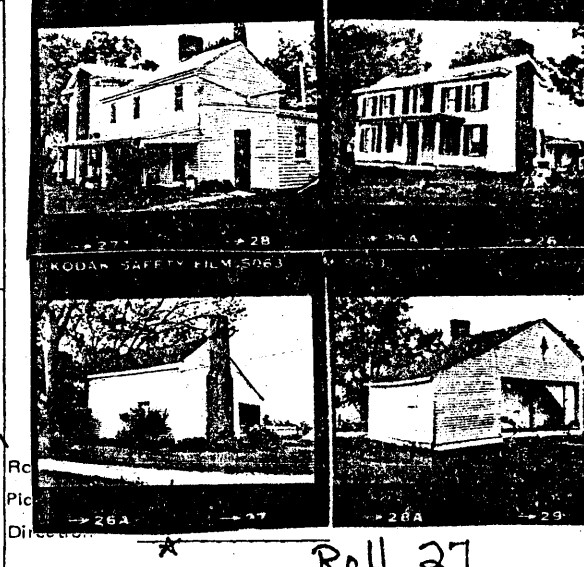

19. History William W. Merritt Sr. purchased this house for his bride in 1844. She was Mary Virginia Kelley of the Kelley-Meyor homestead. - one of two of their daughters married William Thomas Hardin and J. M. Hardin. This homestead has remained in the family for 130 yrs.

20. Significance particularly clear illustration of common type and style; structure that embodies an early manner of building

33. Tape No. Negative No.

34. Prepared by: KTG-JCH

35. Organization KHC

36. Date Spring 1978

21. Source of Information * Sumpter, An Album of Early Warren County landmarks

37. Revision Dates 38. Staff Review

Architecture:

116. The two houses on this site represent in well preserved form two of the most popular building types in Warren County domestic architecture: the square, single pen log house and the frame Greek Revival I-house. The square, single pen log house dominated the landscape in the first third of the century and the frame Greek Revival I-house in the second third. The straight-sided chimneys of the frame house were a popular local alternative to shouldered chimneys in the mid-nineteenth century.

