

KENTUCKY HISTORIC RESOURCES INVENTORY

1. Name of Site: Jesse Kirby Springhouse		16. Date: Early 19th century	[2] []
2. Prehistoric Site	Building X Object	17. Style: Federal, Vernacular	[B] []
Historic Site	Structure Other	18. Architect/Builder:	
3. Location: East side Love Howell Road 1 1/2 mile south of U.S. 231 <i>near</i>		19. No. of Stories: One	[A]
4. ADD/County: Barren River/Warren <i>Bowling Green</i> [114]		20. Original Floor Plan: Single Cell	[B]
5. Original Owner: Jesse Kirby, Sr.		21. Single File Double File N.A.	X
6. Other Names:		22. Roof Form & Original Material: Gable	
7. Owners Name: Mary Lois & Steve Wheeler		23. Structural Material: Stone	[B]
8. Owners Address: Route #2, Box 59 Alvaton, Kentucky 42122		24. Exterior Finish: Stone	[s]
9. Evaluation: Meets National Register [D]		25. Foundation Material: Stone	[A]
10. Status & Date:		26. Major Alterations:	
Nat.Landmark	KY Survey	Moved	Wall Treat.
Nat.Register	Local Landmark	Additions	None
Landmark Cert.	HABS/HAER	27. Outbuildings: Greek Revival House, log frame bank barn [5]	
11. N.R.Group		28. Original Use: Springhouse [C]	
District Name	[]	29. Present Use: Springhouse	
Mult.Resource Area	[]	30. Condition: Good [B]	
Thematic Name	Early Stone Buildings []	31. Endangered	Yes No X
12. Historical Theme:		31. Attach Photos Roll: Stone 18/19 Photo Nos: 30-35/1-15 (slides also)	
Primary:	Architecture [C]		
Secondary:	[]		
Other:	[]		
13. Statement of Significance: One of two dry stone buildings in county. Part of excellent group of early farm buildings at site. Rare (in Kentucky) bank barn.			

14. History:
Spring house built by Jesse Kirby, Sr., Revolutionary soldier from North Carolina and Virginia, who received land grant for services. Built log barns and dependencies and log house which was replaced by the present Greek Revival house of Leander Harris. The garage was built by Love Howell to house the county's first Model T.

15. Source of Historical Information:	33. Prepared by: Carolyn M. Wooley
44. Inspection	34. Organization: Kentucky Heritage Council
14. Daughter of Love Howell, and <u>An Album</u>	35. Date: March 1984
of Early Warren Co.Landmarks. pp.118-119.	

JUN 6 1984

KENTUCKY HISTORIC RESOURCES INVENTORY

36. UTM Point of Primary Building: <u>16.553310.4082390</u>	37. USGS Quadrant: <u>Bowling Green, S.</u>	38. G.I.S. Mod. []	39. Coordinate Accuracy []
40. UTM Points of Boundary:			
A. <u>16/554190/4082370</u>	C. <u>16/553420/4082290</u>	E. <u>16/553470/4082530</u>	
B. <u>16/553600/4082280</u>	D. <u>16/553415/4082530</u>	F. <u>16/553500/4082750</u>	
41. Total Acreage in Present Property: <u>174 acres</u>	42. Acreage Included in Nominated Boundary: <u>ca.64</u>		
43. Site Plan and Boundary Description and Justification:			

Attached

44. Description and House Plan:

One story dry laid stone springhouse. Masonry of squared blocks laid in straight courses on front, broken courses on rear and ends. Upper Mississippian Mgl limestone. Built at foot of steep hill below cave from whence spring emerges. Part of spring branch is diverted to run through springhouse, flowing out below front wall. One door, one window on east front, one window north end, one door south end. Windows are horizontal rectangles, frames pegged. Frame gables. Masonry repointed.

A steep drive descends the hill from the pike. The drive is paved with 4'-5' slabs of stone, 18" thick (which have been recently coated with asphalt). A mid-19th Century central passage frame house, mostly Greek Revival, some Gothic Revival, replaces the original log house. House has stone foundation, interior brick chimneys, square cut window frames with applied flat trim, square porch piers, balcony with cut out railing, scroll brackets; high basement under wing; interior, four-pane doors, Greek Revival mantels, yellow poplar floors.

Just north of springhouse is a large hewn log frame bank barn for mules and hogs. Log corn crib, log tool house, T.O.C. garage and chicken house (sawn frame, former slavequarters).

KENTUCKY HISTORIC RESOURCE INVENTORY SUPPLEMENT
BOUNDARY AND LOCATION INFORMATION

Historic Property Name Jesse Kirby Spring house Site # VA 198
Multiple Resource/Thematic Nomination Title Early Stone Buildings of Ky.

U.T.M. Coordinates - List multiple UTMs if property is ten or more acres.

- | | |
|---|---|
| A. <u>16</u> <u>554190</u> <u>4082370</u> | D. <u>16</u> <u>553415</u> <u>4082530</u> |
| B. <u>16</u> <u>553600</u> <u>4082280</u> | E. <u>16</u> <u>553470</u> <u>4082530</u> |
| C. <u>16</u> <u>553420</u> <u>4082290</u> | F. <u>16</u> <u>553500</u> <u>4082750</u> |

Verbal Boundary Description

Acreage ca. 64 acres

Site enclosed by A-B-C-D-E-F as shown. A-B-C and D-E-F are with property lines, C-D is with the road. F-A is an old fence line.

Sketch of Site Plan (Showing outbuildings, structures, landscape features and the site boundary as described above.)

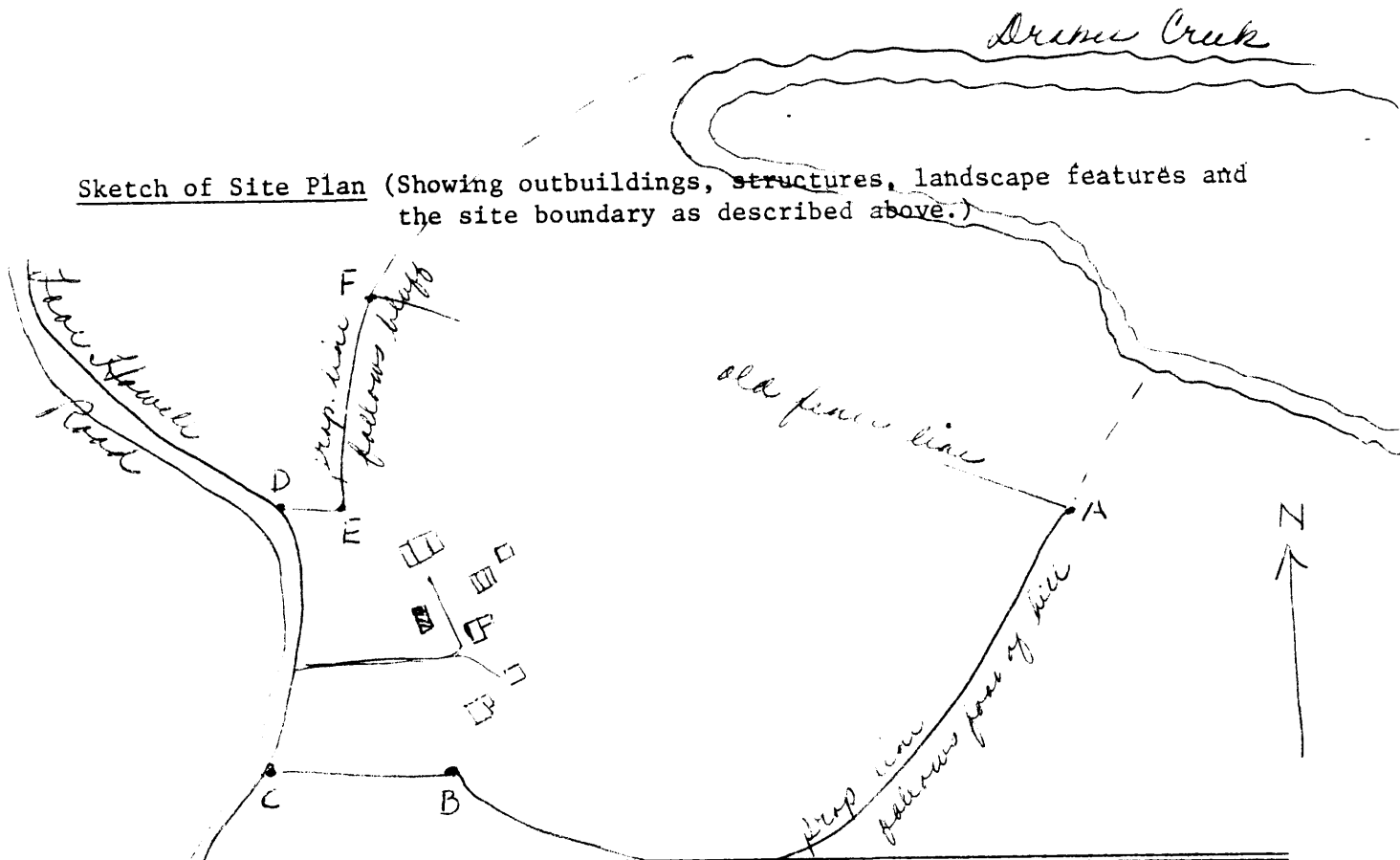

Official Courthouse Property Reference:

Na-198
p. 4 of 6

Armenia Creek

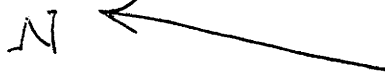

prop. line follows foot of hill

prop. line follows bluffs

log corn crib

tool shed
(not old)

new log frame

garage

house

chicken house
would be here

new log frame
bank barn

spring house

lime pond with
stone slab

steep hill

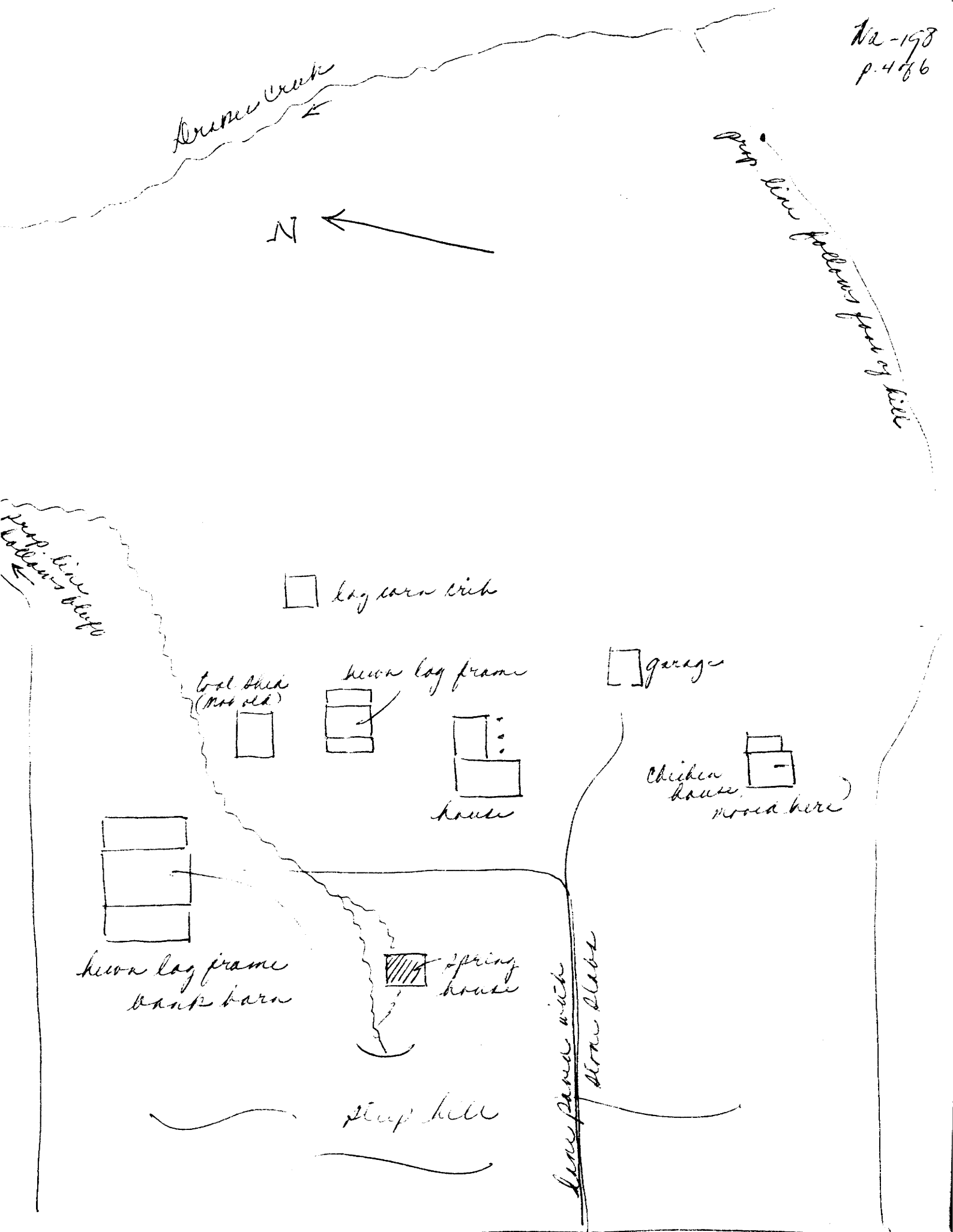



An unpublished history of the family relates, "About the year A.D. 1805 Thomas Keown and his family ... moved from South Carolina to Kentucky and settled in Warren County nine miles north of Bowling Green in what was a wilderness of wilds of the Green River Country where he and his wife continued to reside the remainder of their days. He died June 8, 1808 and his mortal remains were laid to rest in the Watt Graveyard. His widow survived him until 1833 when she died and her body was interred in the Peñner Graveyard."



Jesse Kirby Sr. Leander Harris- Love Howell Home

This home was originally that of Mr. and Mrs. Leander Harris built on land taken up by Jesse Kirby Sr., for services rendered in the Revolutionary War. Jesse Kirby enlisted in the war in 1780 in Henry County, Virginia, along with seven of his brothers. In 1778, in North Carolina, he married Sophia Choice. At first, as with all the earliest pioneers they lived in a log house on this spot close by a spring. The location of the Kirby log house at the foot of a steep hill was so pleasing that when the Leander Harrises made plans to build their new home the log house was torn away and the above residence built on the original site. The spring house, also pictured, built by Jesse Kirby Sr., remains as it was placed there about one hundred and fifty years ago.

On top of the hill which overlooks the beautiful home is the old Kirby family burying ground. As years passed many of the family were buried there but time and weather have taken their toll of the stones and today only a few remain. However, fortunately, the stones of Jesse Kirby Sr., and his wife Sophia are still there bearing witness to the fact that they both lived to be ninety six and ninety three years of age, respectively. This couple had a large family including: David, Nancy, Lucy, William, Cyrus, Elizabeth, Jesse R., Isaiah, John C., Polly and Tully C. Kirby.

The Love Howells owned and lived in this home for over forty five years. To reach the house travel out the Scottsville Road to the first road after the Plano Road, turn right for about a mile and the house is on the left down a steep hill, protected and shaded by beautiful trees. The house is ell shape and has three stories. There are two rooms upstairs, two down with halls and two in the ell with a cellar under all the ell. The road leading from the highway to the house is unusual in that it was built by slave labor of eighteen inch thick rocks set end to end.

Leander Harris and his wife who built the present house had no children.



Home of Jesse R Kirby

This lovely and interesting old brick two story house located in the Plano Community on the Matlock Road is presently owned by M.E. Carter who purchased it in 1939. Mr. and Mrs. Carter care for their home with loving hands as it is very old and one of the best built houses in the county. It appears from deeds and suits at the court house that the house was built by Jesse R. Kirby who married Prudence Dishman. Members of the family relate that this home and the nearby old Mose Potter house were erected by the same builder at the same time about one hundred and thirty five or forty years ago. The bricks were made in a kiln on the grounds by slave labor and the floors are all wide plank poplar hand tongue and grooved. The chimneys are huge and well built. The porch has been added as well as the back "lean-to".

Jesse R. Kirby was born 1792, a son of Jesse and Sophia Choice Kirby. In 1818 he married Prudence Dishman and they raised a large family, namely: Harriett, Tuly, Felliciana, Emily Prudence, Elizabeth, Beverly, C. Gallatin, A. Solomon, Serepla Nancy,