

1. Historic Name (s)
William Gossom House
 Original Owner **William Gossom**
 Present Name _____

3. Owner's Name
Eugene Shy

4. Owner's Address
Rt 14 Box 70 Bowling Green

5. Location
W. side 31W; 1/4m N of intrection 31W and 446

6. Open to Public Yes No

7. Visible from road Yes No

8. Ownership Private
 Local
 State
 Federal

9. Local Contact/Organization _____

22. ADD/County **BARTON/WA**

23. Zoning Classification
 Magisterial District

24. U.S.G. S. Quadrant (15'/75')
Bowling Green North

25. UTM Reference
 Zone **116** Easting **555200** Northing **4109614810**

26. Prehistoric Site _____ Object _____
 Historic Site _____ Structure _____
 Building

27. District Name: Yes No

28. Significance Evaluation **NR**

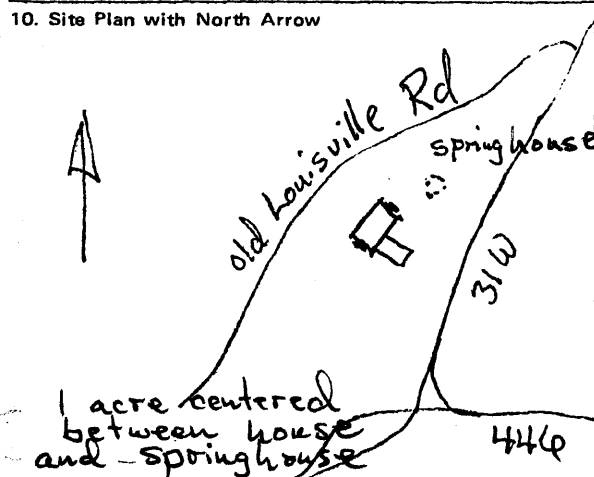

11. Architect _____

12. Builder _____

13. Date **(1810-15)**
1st 1/3 19th c

14. Style **Federal**

15. Original Use **dwelling**

16. Present Use **dwelling**

17. Condition Interior Exterior **good/alterd**

29. Status _____ Date _____

National Landmark
 National Register
 Landmark Certificate
 Kentucky Survey
 Local Landmark
 HABS/HAER

30. Theme Primary Secondary Other

31. Endangered Yes No

18. Description **2 story - 3 bay brick - Flemish bond - jack arches over openings - exterior step - shouldered brick end chimney on right end - interior brick end chimney on left - later one story addition on right side - one story ell separated by breeze way - now raised to 2 - and connected - main door altered - hall and parlor plan, - 1 story stone springhouse**



19. History **Built by William Gossom - born in Va in 1774 came to Ky in 1808 - the home was built not long after that - He acquired much land through 32 years which eventually extended down to wings Ford on the Barren River - William Gossom died in 1862 and the property went to daughter Elizabeth Gossom Roberts - her husband Edwin Roberts was captain of a Steamboat called "The Braelet" which belonged to Charles Van Meter - later he formed a company with**

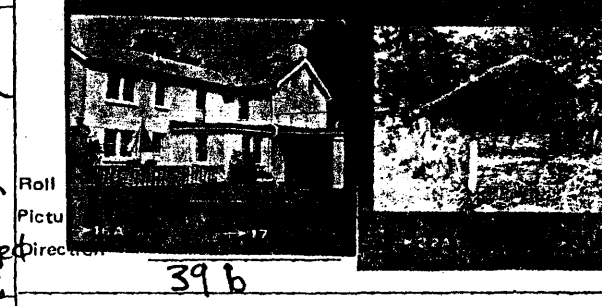

20. Significance **a Roberson and they owned there several years - until the Civil War when they dissolved. Structure that embodies an early type, style and manner of building. second original owner had connections with Barren River Commerce**

34. Prepared by: **KTG-JCH**

35. Organization **KHC**

36. Date **Spring 1978**

21. Source of Information **Sumpter, An Album of Early Barren County landmarks**

37. Revision Dates _____ 38. Staff Review _____

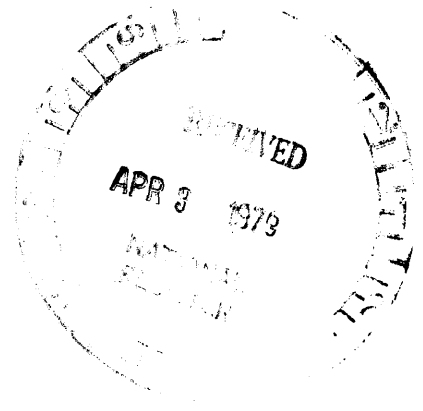

Architecture,

73. This house is one of six highly significant Federal style brick houses in the county based on the hall and parlor plan type. Later additions and alterations have not obscured the classic two-storied, three-bayed form common in such houses. The significance of the house is increased by the survival of a nearby stone springhouse, by the prominent location at the intersection of several main highways, and by the connections of the son-in-law of the original owner with Barren River commerce.