

1. Historic Name (s) Drakes Creek Baptist Church  
 Original Owner Trustees Drakes Creek Baptist Church  
 Present Name Burton Memorial Baptist Church  
 3. Owner's Name Trustees Burton Memorial Baptist Church  
 4. Owner's Address Rt. 2 Bowling Green  
 5. Location S. side Rt. 234 (Cemetery Rd.); 1 m. E. of I 65  
 6. Open to Public  Yes  No  
 7. Visible from road  Yes  No  
 8. Ownership  Private  Local  State  Federal  
 9. Local Contact/Organization

22. ADD/County WARREN, WA  
 23. Zoning Classification Magisterial District  
 24. U.S.G. S. Quadrant (15'/75') Bowling Green South  
 25. UTM Reference 116 5155180 41091101010  
 26. Prehistoric Site  Object  Structure  Building  
 27. District Yes  
 Name:

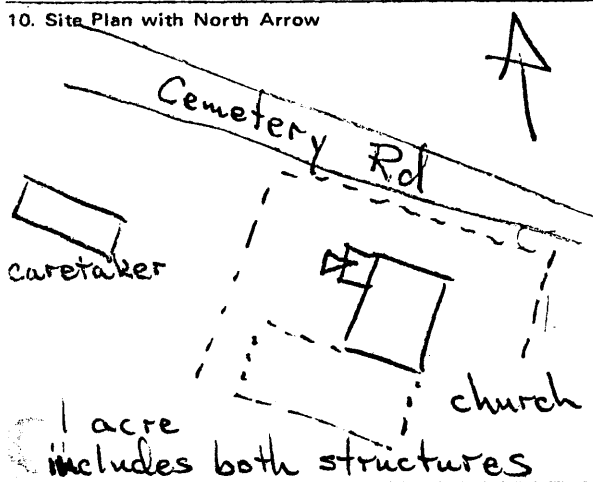

11. Architect  
 12. Builder W. H. Burton \*\*  
 13. Date 1911 \*  
 14. Style eclectic  
 15. Original Use church  
 16. Present Use church  
 17. Condition  Interior excellent  Exterior excellent

28. Significance evaluation NR  
 29. Status  National Landmark  National Register  Landmark Certificate  Kentucky Survey  Local Landmark  HABS/HAER  
 30. Theme  Primary architecture  Secondary religion  Other  
 31. Endangered  Yes  No

18. Description gable end - rough cut stone - side entry porch - fine stonework - intact interior - recent addition on rear - original iron and stone fence  
- one story frame caretaker's building - shingled

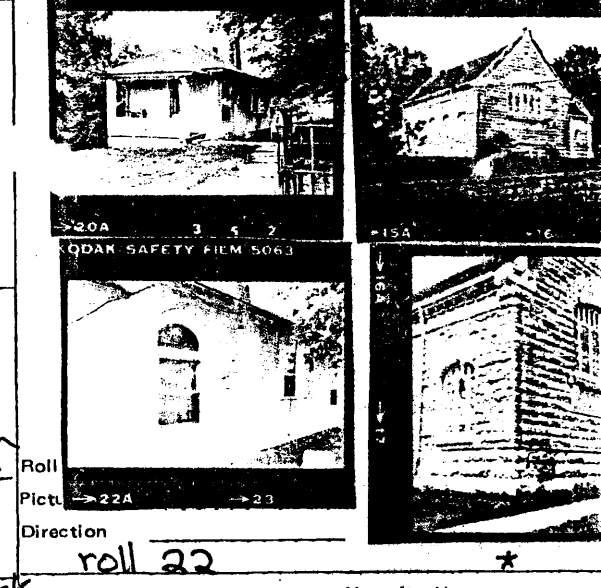

19. History \*\* Originally known as Drakes Creek Baptist Church - It was established in 1850 by the United Baptist - According to Church records, negro slaves were admitted as early as 1851 - The first church building was frame - In 1909 W H Burton church member, proposed that he build a new stone building with the only stipulation being that it be named in memory of his parents - charter members of the church - The building was completed in 1911 -  
 20. Significance Built entirely by hand using Warren Co. rock structure that exhibits qualities of outstanding architectural design and craftsmanship; surviving complementary structures and landscape elements. One of the oldest established churches in Warren County.

33. Tape No. KTG - JCH Negative No.  
 34. Prepared by:  
 35. Organization KHC  
 36. Date Spring 1976  
 37. Revision Dates 0 38. Staff Rev.

21. Source of Information \*\* Church Bulletin

## Architecture;

80. This is one of the few instances in the region of a group of contemporary, apparently architect-designed buildings. The outstanding architectural design and workmanship of the stone church is supplemented and balanced by the sensitively detailed, shingled caretaker's cottage and by the fine iron and stone fence that surrounds the church on three sides. The church interior is essentially intact, and a later recent rear addition has left the rear wall of the original building exposed in its interior.

