

1. Historic Name (s) A.C. Davidson House

Original Owner _____
Present Name _____

3. Owner's Name Carley Dickerson

4. Owner's Address Cemetery Rd - Bowling Green Ky
at elevation

5. Location 1 m. W. of Leayou Rd.; beginning of lane is 2 m S.

6. Open to Public Yes No

7. Visible from road Yes No

8. Ownership Private
Local
State
Federal

9. Local Contact/Organization _____

22. ADD/County BARTON

23. Zoning Classification Magisterial District

24. U.S.G. S. Quadrant (15'/75') Allen Springs

25. UTM Reference 116 55171026 410718240
Zone Easting Northing

26. Prehistoric Site _____ Object _____
Historic Site _____ Structure _____
Building

27. District Yes No
Name: _____

28. Significance Evaluation NR

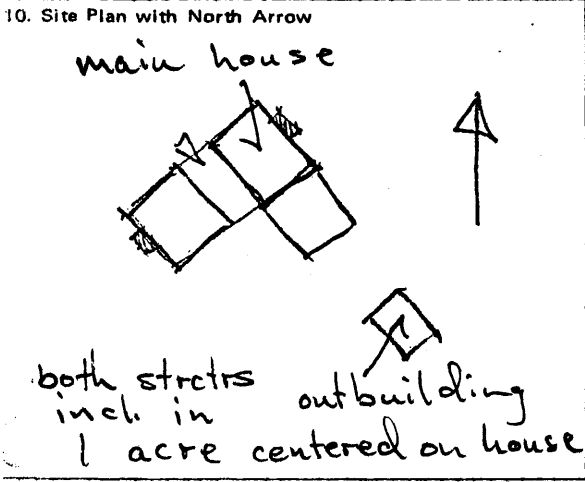

11. Architect _____

12. Builder _____

13. Date from 1st 1/3 19thc

14. Style dogtrot log

15. Original Use house

16. Present Use house

17. Condition Interior Exterior good

29. Status National Landmark _____
National Register _____
Landmark Certificate _____
Kentucky Survey _____
Local Landmark _____
HABS/HAER _____

30. Theme Primary log houses
Secondary architecture
Other _____

31. Endangered Yes No

18. Description 2 story dogtrot form - log - two exterior end stone chimneys - step shouldered (right) regular coursed - dog trot enclosed - slope shouldered (left) - slope shouldered (ell) - square notched outbuilding - porch (later) in angle of ell left pen probably first - rear pen and right pen later - half dovetail notching on outbuilding - rear and right chimneys have foundation ledges

19. History right pen - half dovetail - sited on rise in bend of Drake's Creek

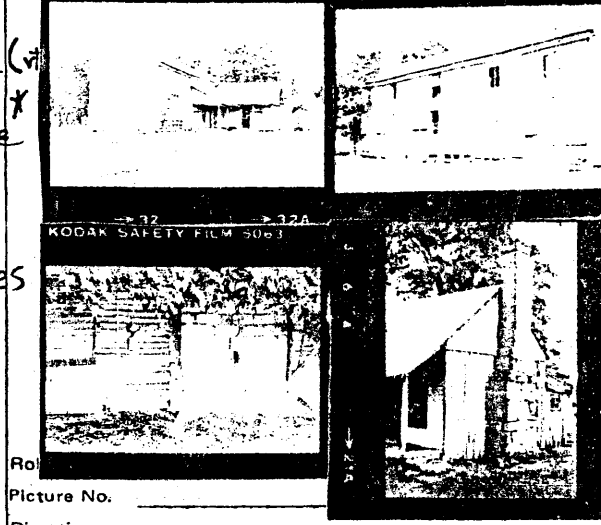

20. Significance 1877 Beers Atlas - A.C. Davidson, Hill particularly clear illustration of a historic attitude toward the relationship between structure and landscape; clear illustration of a common type and structural technique.

21. Source of Information _____

NOV 3 1980



NOV 26 1988

Architecture

91. This complex of log buildings is one of the clearest illustrations in the county of the use of log construction in the accretive increase of domestic space. Several building stages produced the two-storied main block in dogtrot form with a one-storied, single pen ell and a nearby single pen outbuilding. The significance of the group of log buildings is enhanced by the sensitive siting on a low rise above the bottom land in a bend of Drakes Creek in a manner representative of early nineteenth century attitudes of domestic siting. The house is the most distinguished of fifteen log structures along Drakes Creek.

UNITED STATES DEPARTMENT OF THE INTERIOR
NATIONAL PARK SERVICE

**NATIONAL REGISTER OF HISTORIC PLACES
INVENTORY -- NOMINATION FORM**

Warren County Multiple Resource Area
Warren County, Kentucky

FOR NPS USE ONLY	
RECEIVED	NOV 13 1980
DATE ENTERED	NOV 26 1980

CONTINUATION SHEET

ITEM NUMBER

PAGE

ADDENDUM

Wa-91

The A. C. Davidson house is unoccupied and has been neglected, but it is in sound structural condition. Despite lack of recent maintenance, the roof is intact; despite the removal of weatherboarding in several places, the fabric of the log house is well-preserved; the stone chimneys show no signs of structural weakness.