

1. Historic Name (s) David C. Campbell House
 Original Owner David C. Campbell
 Present Name _____
 3. Owner's Name Kenneth Deputy
 4. Owner's Address Rt 16 Box 141
 5. Location W. side Beech Bend Rd.; 1 1/4 m. from B.G. limits
 6. Open to Public Yes No
 7. Visible from road Yes No
 8. Ownership Private
 Local
 State
 Federal
 9. Local Contact/Organization _____

22. ADD/County BARRIV, WA
 23. Zoning Classification Magisterial District
 24. U.S.G. S. Quadrant (15/75') Bowling Green North
 25. UTM Reference 116 5518210 409171410
 Zone Easting Northing
 26. Prehistoric Site _____ Object _____
 Historic Site _____ Structure _____
Building
 27. District Name: Yes No

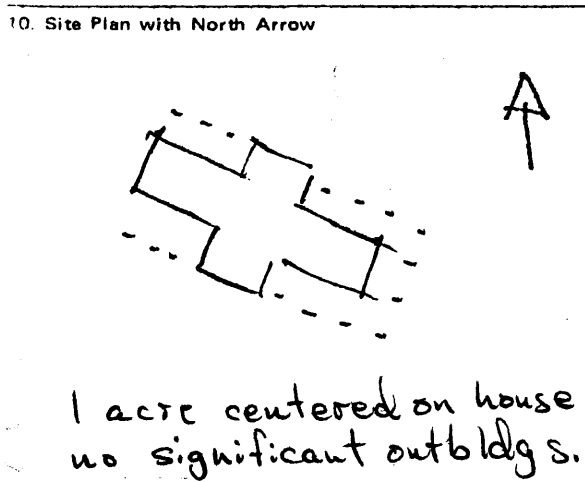

11. Architect _____
 12. Builder David Campbell
 13. Date 1866*
 14. Style Italianate
 15. Original Use dwelling
 16. Present Use dwelling
 17. Condition
 Interior _____
 Exterior excellent

28. Significance Evaluation NR
 29. Status _____ Date _____
 National Landmark
 National Register
 Landmark Certificate
 Kentucky Survey
 Local Landmark
 HABS/HAER
 30. Theme architecture
 Primary _____
 Secondary _____
 Other _____
 31. Endangered Yes No

18. Description 2 story brick - T-plan - common bond - segmental arches - rear T with galleries on both sides in angle of T - interior chimneys - original porches and galleries - wooden bracketed cornices -



19. History David Campbell the original owner was born in Bowling Green in 1823 - Went to California when the '49 gold rush began - Returned in 1851 - David Campbell ran a saw mill located on the present site of the Bob White Packing Co. on Richardsville Rd. In 1864 he began saving lumber for his house - according to Grandson it took him two years to assemble enough yellow poplar -

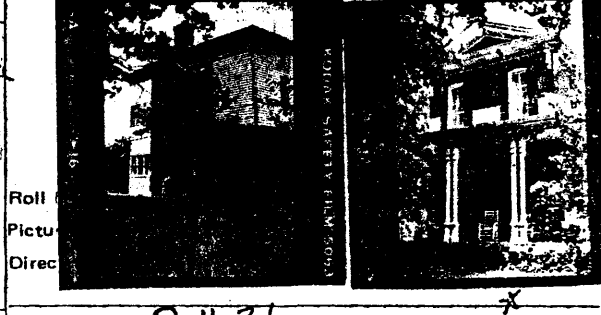

20. Significance particularly clear illustration of a common type and style; exhibits qualities of outstanding design and craftsmanship.

33. Tape No. Roll 36 Negative No. _____
 34. Prepared by: KTG-SCH
 35. Organization KHC
 36. Date Spring 1978

21. Source of Information *Sumpter, An Album of Early Warren County Landmarks

37. Revision Dates _____ 38. Staff Review _____

Architecture :

165. One of the few dwellings in Warren County in a nominally Italianate style, this building is also one of the few to exhibit this particular kind of T-plan or cross-gable plan (see Wa-163). All of the interior and exterior has survived. The extensive use of one-storied porches and double galleries is highly unusual in the area and contributes to the well composed, varied mass of the building.

